

TS-202003
Forest County

SALE NAME: Little Popple River

Sale Type – Ticket (Mill scale) for Pulp & Bolts – Logs Scaled

SALE LOCATION

Forest County, Township of Ross
Sections: 5, 6 Town 37N Range 14E
T38N-R14E Section 21
Sale Area: 130 Acres

Contract Period: 3 Years

**Contacts: John Schwarzmann, 715-277-3366 – 715-892-0662 (C)
Kevin Burns 715-360-7438 (C)**

Timber sold under this contract is certified. FSC® 100%:



Legal Descriptions

<u>Town and Range</u>	<u>Section</u>	<u>Quarter-Quarters</u>	<u>Section</u>	<u>Quarter-Quarters</u>
T37N-R14E	5	NW1/4,	6	SWNE, SENE, NESE
T38N-R14E	32	SESW		

Cutting Requirements

- 1) Cut all trees marked in orange paint.
- 2) Cut all balsam fir with one or more sticks
- 3) Cutting lines are marked with blue property boundaries, red cutting lines or swamp edges.
- 4) Winter logging from Dec 1 to April 1 under frozen conditions or deep snow.

Timber Volume Estimates & Minimum Bid Values

<u>Pulpwood & Bolts (Tons)</u>	<u>Estimated Volume</u>	<u>Minimum Bid</u>
Balsam fir	60 Tons	\$6.00/Ton
Basswood	30 Tons	\$6.00/Ton
Mixed Hardwood	2,400 Tons	\$10.00/Ton

<u>Sawtimber (MBF)</u>	<u>Estimated Volume</u>	<u>Minimum Bid</u>
Basswood	4 MBF	\$180.00/MBF
Black Cherry	1 MBF	\$325.00/MBF
Red Maple	5 MBF	\$200.00/MBF
Sugar Maple	60 MBF	\$440.00/MBF
Yellow Birch	2 MBF	\$300.00/MBF

**ADVERTISED VALUE / MINIMUM ACCEPTABLE BID: \$53,585 Volume per acre: 10.0 Cord Equiv./acre
25.0 Tons/acre**

SALE OBJECTIVES: The harvest objective is to maintain a multi-aged stand of high-quality hardwood timber by carefully managing existing crop trees and releasing saplings that are becoming suppressed. Single-tree selection is used to release crop trees and to limit the area in large gaps which can convert in to berry bushes. Marking removed suppressed, poor- quality trees, prime veneer and mature sawlogs. Yellow birch and basswood have a high proportion of grade 1 logs, some veneer, while sugar maple has some grade 1 but with most of the rest in grade 2.

Access & Terrain- Site can be reached by coming up from Hwy G and taking graveled logging roads. **The logging roads coming off the esker in Section 5 will be fixed and in good condition for hauling so access will be greatly improved.** Terrain is rolling hills. Soils are silt loam and with some wet swales. The logging roads do not drain quickly. Skid distances are very short.

OTHER SALE REQUIREMENTS AND CONDITIONS:

- The BCPL can restrict the type of equipment used on the job if conditions or damage warrant.
- BMP's (see Field Manual PUB-FR-093-2010) are mandatory for this sale.
- Notify the BCPL (715-277-3366) before you start the job.
- Sawlog volume estimates are from a 100% tally. Hwd pulp is estimated at 2.50 tons/cd.
- **4% discount off stumpage prices for cutting in the first year. 2% discount the second year!**

Timber Sale Bid



Date _____

I herewith submit the following bid for timber described below. I also understand that if I am awarded the contract and fail to sign it, I may be barred from bidding on future BCPL timber sales.

Completion of this form is mandatory. The BCPL will not recognize your bid unless you complete and submit this form. Personal information on this form will not be used for any other purpose.

Common Name (If any):				Timber Sale Number
Date and Hour of Bid Opening: June 19, 2020 10:01AM				TS-202003
Species	Estimated Volume	Min. Required Bid Per Volume Unit	Price Bid Per Volume Unit	Total Bid Value on Estimated Volume
Basswood	4 MBF	\$180.00		
Birch, Yellow	2 MBF	\$300.00		
Cherry, Black	1 MBF	\$325.00		
Maple, Red	5 MBF	\$200.00		
Maple, Sugar	60 MBF	\$440.00		
Balsam Fir	60 TONS	\$6.00		
Basswood	30 TONS	\$6.00		
Hardwood	2,400 TONS	\$10.00		
The award shall be based on this TOTAL BID AMOUNT:				\$

DO NOT SEND ANY FUNDS (DEPOSIT), with the bid form.
A 35% deposit is only required from the highest (winning) bidder.

35 % Performance Bond WILL BE (check one):

Check
 Certified Check/Money Order
 Letter of Credit
 Assurance Bond

I understand that any or all bids may be rejected and that consideration and awarding of a contract will be based upon my past performance and ability to complete contracts.

A copy of the standard timber sales contract, which must be entered into, is available upon request from the BCPL.

All bids including Lump Sum bids must be by species.

Bidder's Signature: _____ Street or Route _____
 Bidder's Name: _____ City, State, Zip _____
 Office/Home Phone # (____) _____ Cell Phone # (____) _____

BCPL - TS-202003 - Little People River Timber Sale Locator Map

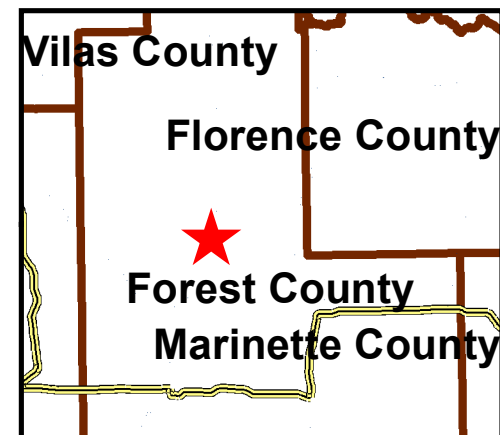
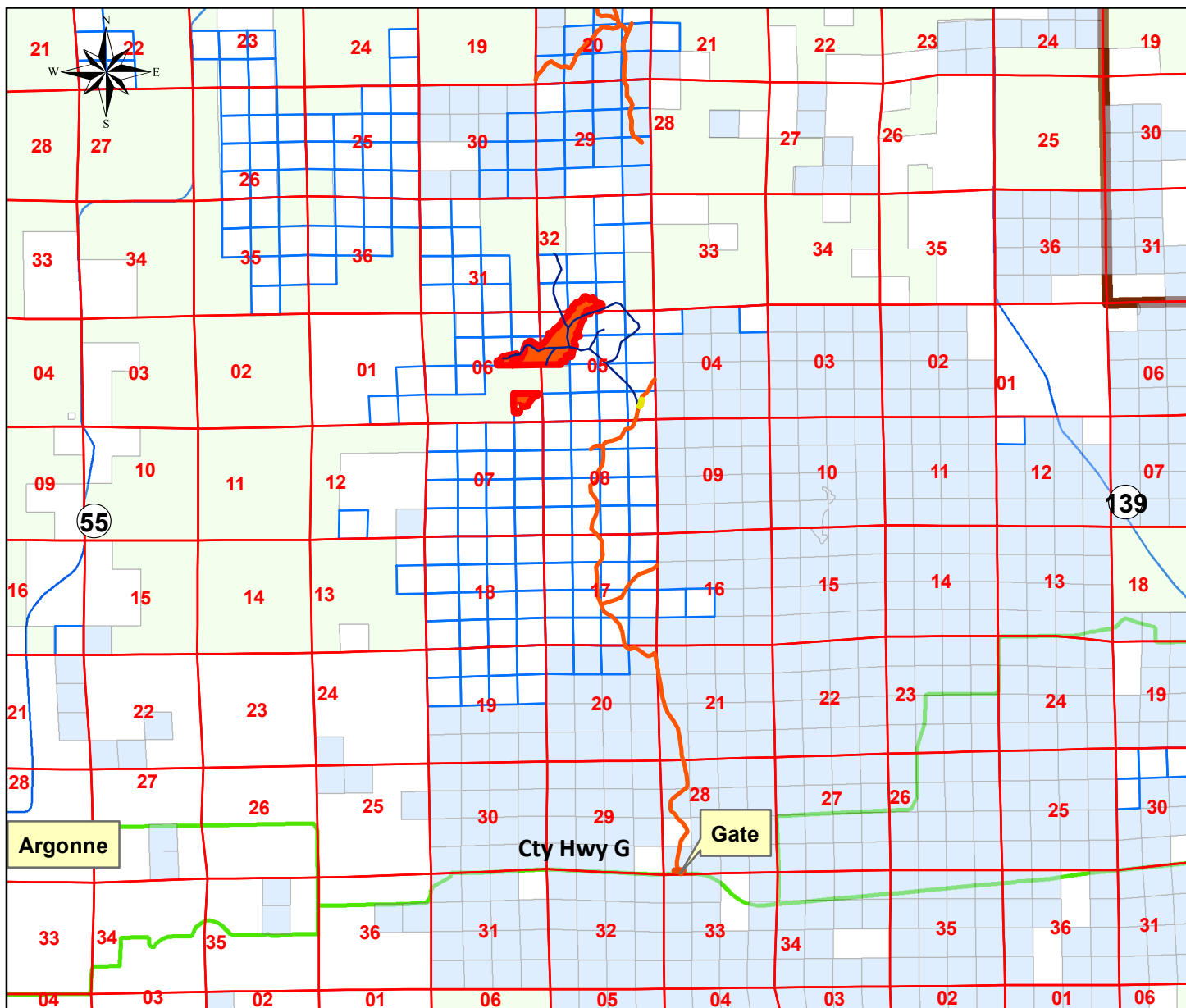

Legend

- Woods Roads
- Easement Road
- TS-202003
- Sections
- BCPL Lands
- Nicolet National Forest
- County Trunk Highway
- State Trunk
- Managed Forest Law-MFL**
- Open

Scale: 1:80,000

Harvest Area: 120 Acres

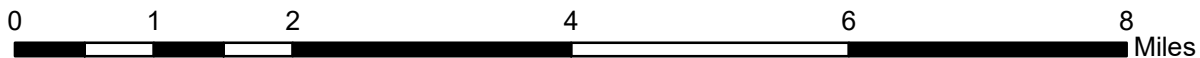

BCPL - TS-202003 - Little Poople River Timber Sale
T37N-R14E Section 5, NW1/4, Section 6 SWNE, SENE, NESE
T38N-R14E Section 32 SESW
Town of Ross, Forest County WI

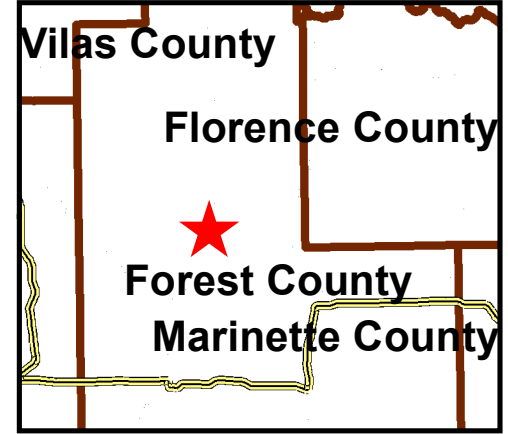
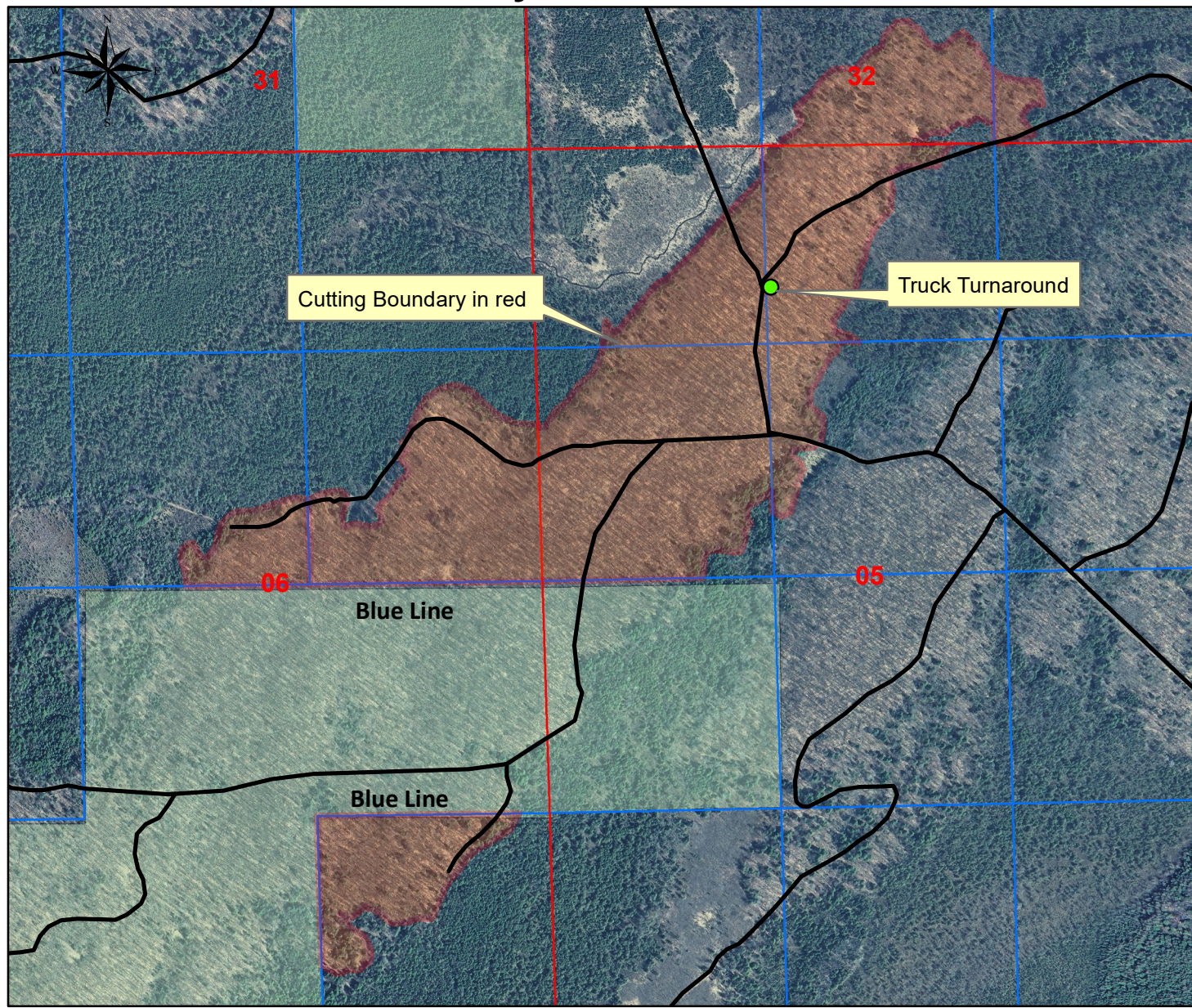

Legend

- Woods_Roads
- TS-202003
- Sections
- BCPL Lands
- Nicolet National Forest

Cutting Requirements
 Cut all trees marked in orange paint.
 Cut all balsam fir with one or more sticks.

Scale: 1:10,000
Harvest Area: 120 Acres

